

## PAH200H Series

High Current Half Brick  
DC-DC Converters

- Industry Standard Package
- Low voltage outputs to 0.96V
- Output Currents up to 70A
- Designed for telecom standards
- Output voltage adjustment
- Remote On / Off

### Key Market Segments & Applications

Central Office: ATM, Sonet, DSL, ISDN, Frame relay  
 Broadband: Switching Equipment, Routers  
 Remote Electronics: Fixed Local Loop, Fiber Optic Transmission, Microwave Transmission, Wireless Local Loop  
 Customer Premise: PBX, PABX, Datacomm, Voice Systems, Video Conferencing  
 Industrial: Systems, Video Conferencing, Distributed Power Applications

### PAH200H Features and Benefits

#### Features

- High Efficiency
- Wide adjustment range
- ASIC Design
- No potting materials

#### Benefits

- Reduces System Heating
- Reduces need for custom modules
- Reduced component count, increased MTBF
- Lower weight

### Specifications

MODELS		PAH200H48-1R2	PAH200H48-1R5	PAH200H48-1R8	PAH200H48-2R5	PAH200H48-3R3
ITEM						
Nominal Output Voltage	VDC	1.2	1.5	1.8	2.5	3.3
Output Current (Max)	A	70	70	70	70	60
Max Output Power	W	84	105	126	175	198
Efficiency (Typ)	%	82	84	87	88	90
Input Voltage range	VDC	36-76V(100V for100ms)				
Input Current (typ)	A	2.19	2.67	3.08	4.23	4.68
Output Voltage Accuracy	%	±1				
Output Voltage Adjustment	V	0.96-1.32	1.2-1.65	1.44 - 1.98	2.0 - 2.75	2.805-3.795
Max Ripple & Noise	mV	100				
Max Line Regulation	mV	10				
Max Load Regulation	mV	10				
Overcurrent Protection	-	105 - 140% (See Options)				
Overvoltage Protection	-	120 - 140% (See Options)				
Remote Sense	-	Yes				
Remote On / Off	-	Yes (See options)				
Operating Temperature	-	-40°C to +85°C (100°C /B option) Baseplate temperature				
Operating Humidity	-	5 - 95% Non condensing				
Storage Temperature	-	-40°C to +100°C				
Cooling	-	Convection, or forced air				
Withstand Voltage	-	Input to Output 1500VAC for 1 min.				
Vibration (non operating)	-	10~55Hz (1 minute), amplitude 0.825mm (49m/s <sup>2</sup> max), X, Y, Z 1 hr ea.				
Shock	-	196.1 m/s <sup>2</sup>				
Safety Agency Approvals	-	IEC60950-1, EN60950-1, UL/CSA60950-1				
Weight (Typ)	g	90				
Size (WxHxD)	mm	57.9 x 10.2* x 61 * /B version 12.7				
Warranty	-	2 Years				

**Notes:** See Installation Manual for full details, test methods of parameters and application notes.

Outline Drawing PAH200H/B

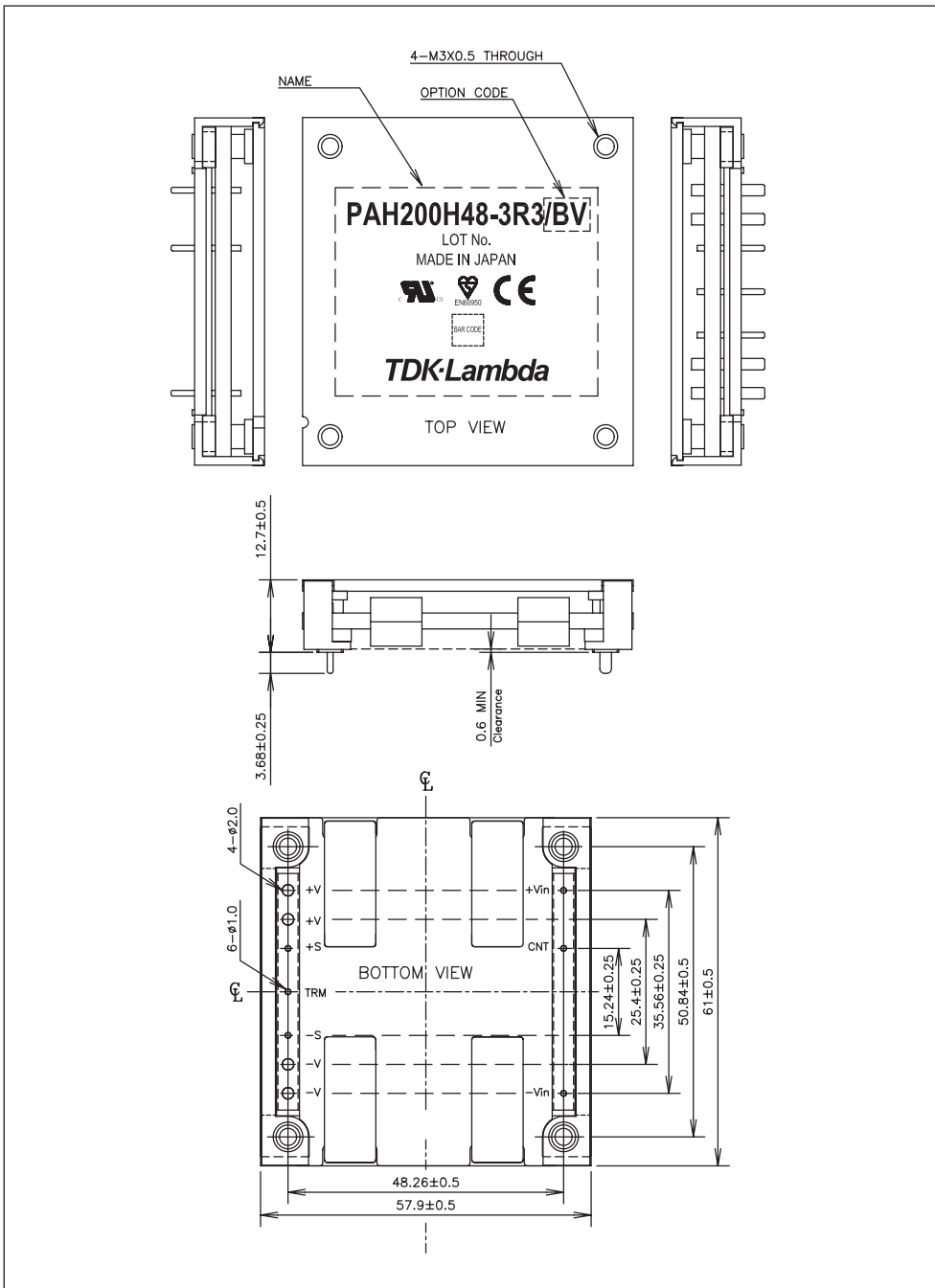

Options

Suffix	OCP / OVP	Remote On / Off
Blank	Manual Reset	Negative, Short = On
/V*	Auto Reset	Negative, Short = On
/P	Manual Reset	Positive, Open = On
/PV*	Auto Reset	Positive, Open = On
/C**	Single set of O/P pins	
/B	Baseplate Fitted	

**Note:** Suffix letter order: /C followed by /P followed by /V  
 Example: /CPV.  
 \* Standard US Stock Item.  
 \*\* See website for outline drawing—not available with /B option.

## Outline Drawing PAH200H

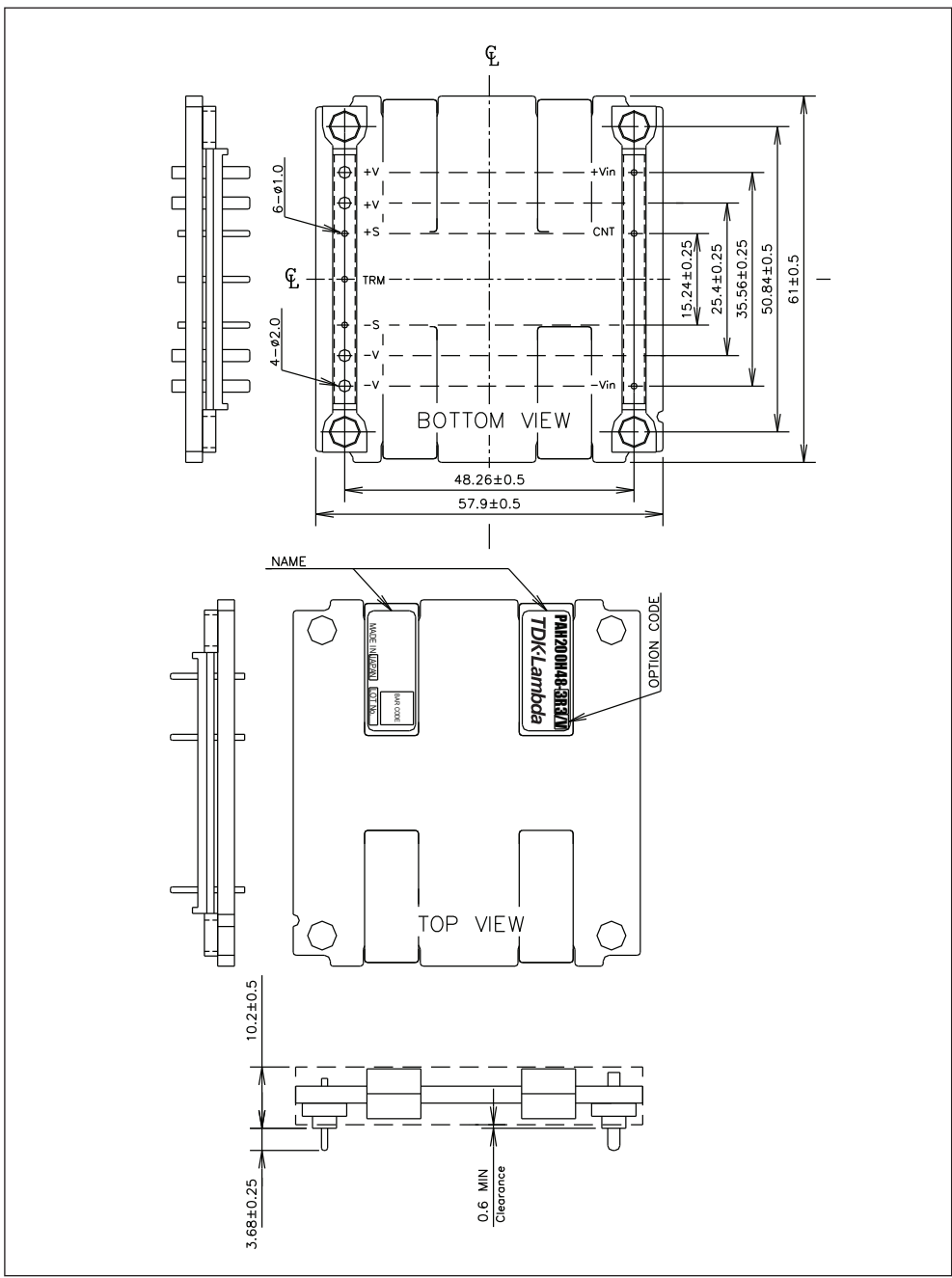

Pinout	
Pin Description	Function
-Vin	Negative Input Terminal
+Vin	Positive Input Terminal
CNT	On / Off Control terminal
+V	Positive Output Terminal
-V	Negative Output Terminal
TRIM	Output adjustment Trim pin
+S	Positive Remote sense
-S	Negative Remote sense